

CONTINUATION SHEET

AIA DOCUMENT G703

PAGE OF PAGES

AIA Document G702, APPLICATION AND CERTIFICATION FOR PAYMENT, containing Contractor's signed certification is attached.

APPLICATION NO:
APPLICATION DATE:

In tabulations below, amounts are stated to the nearest dollar.

PERIOD TO:

Use Column I on Contracts where variable retainage for line items may apply.

ARCHITECT'S PROJECT NO: TIGRETT

A ITEM NO.	B DESCRIPTION OF WORK	C SCHEDULED VALUE	D WORK COMPLETED		F MATERIALS PRESENTLY STORED (NOT IN D OR E)	G TOTAL COMPLETED AND STORED TO DATE (D+E+F)	H BALANCE TO FINISH (C - G)	I RETAINAGE (IF VARIABLE RATE)
			FROM PREVIOUS APPLICATION (D + E)	THIS PERIOD				
1	CONSTRUCTION STAKES, LINES, AND GRADES	\$2,250.00						
2	CLEARING AND GRUBBING	\$650.00						
3	REMOVAL OF RIGID PAVEMENT, SIDEWALK, ETC.	\$650.00						
4	SITE EXCAVATION	\$2,000.00						
5	MINERAL AGGREGATE, TYPE A BASE, GRADING "D"	\$4,500.00						
6	PRIME COAT	\$363.00						
7	1E MIX	\$3,990.00						
8	CONCRETE SIDEWALK (4")	\$8,840.00						
9	SIGNAGE	\$270.00						
10	STRIPING	\$935.00						
11	EROSION CONTROL	\$625.00						
12	TESTING	\$1,000.00						
13	SOD	\$1,050.00						
14	CANOPY	\$8,100.00						
15	CONTINGENCY ALLOWANCE	\$7,625.00						
	GRAND TOTALS	\$42,848.00	\$0.00	\$0.00	\$0.00	\$0.00	\$0.00	

Users may obtain validation of this document by requesting of the license a completed AIA Document D401 - Certification of Document's Authenticity

Revised 08-29-13
Revised 02-06-14
Revised 06-05-14

1. All existing utilities shown, both above and below ground, are approximately located and are not necessarily all that exist. The contractor shall field verify utilities prior to construction. Per Tennessee State Law, the contractor shall notify Tennessee One Call (811 or 1-800-855-1111) at least 72 hours prior to digging.
2. The contractor shall be responsible for providing the necessary permits for the construction of the project. The engineer shall prepare a bench mark and horizontal control should they not be stipulated on the drawings.
3. The contractor shall insure that all documents including Notice of Intent (NOI), Storm Water Pollution Prevention Plan, and other environmental documents are submitted to the Tennessee Department of Environment and Conservation (TDEC) for review. A Notice of Construction (NOC) shall be submitted to TDEC.
4. All contractors shall be aware that there may be other contractors on site working on other portions of the project. Contractors shall coordinate and cooperate with each other to avoid conflict and damage to each others work.
5. The contractor shall accept deviations and proposed locations of improvements prior to construction and report any discrepancies to the Engineer.
6. All items of work referred to using the abbreviations "TOD" shall be constructed and tested in accordance with the Tennessee Department of Transportation (TOD) Standard Specifications for Construction, dated January 1, 2015 or latest edition, along with applicable "Standard Drawings" and "Special Provisions".
7. All face of curb (or pavement edge where no curb exists) shall be 5'-0" wide.
8. All sidewalks shall be constructed in accordance with the "TOD" standard specification section 91.01.
9. Accessible route: On all accessible routes the maximum slope along the route shall be 5%. The maximum cross slope shall be 2%. All sidewalks shall be considered accessible routes and sloped away from buildings.
10. The maximum slope in any direction shall be 2% A 5' x 5' area on either side of any door and/or 1' or 2' at the top and bottom of steps shall be considered a landing area. The maximum cross slope shall be 5%.
11. The maximum slope in any direction for handicap parking spaces and access shall be 2%.
12. Prior to placing any fill material or granular base material, the area shall be proof-rolled with a truck loaded to 30 tons, resulting in a maximum deflection of 0.015 inches per inch of depth. The minimum deflection shall be 0.015 inches per inch of depth. The completed subgrade and the granular base shall also be proof-rolled prior to covering with additional materials.
13. All areas shall be constructed using 8" maximum compacted life achieving 95% standard proctor density. For fills of more than 6 (six) feet, compaction shall be 100% standard proctor density. The top one foot of all sub-grades which will be under improvements, including paving, shall be compacted to 100% standard proctor density.
14. All areas shall be constructed using 8" maximum compacted life achieving 95% standard proctor density.
15. Where catch basins are identified on the plans using TODT specification numbers, pre-manufactured catch basins which meet or exceed the minimum area of steel may be substituted. All such substitutions shall be certified by a Tennessee Professional Engineer.
16. All disturbed areas on this project outside of other improvements shall be stabilized with hybrid Bermuda sod.

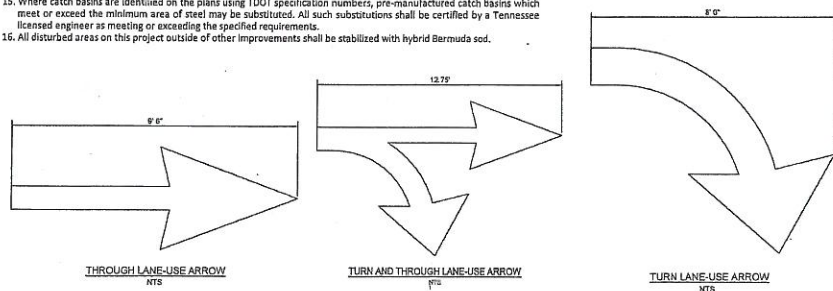

City of Jackson, Tennessee
Deed Book 161, Page 486
Deed Book 162, Page 98
Deed Book 165, Page 626
Tax Map 77D, Grp. E, Parcel 100

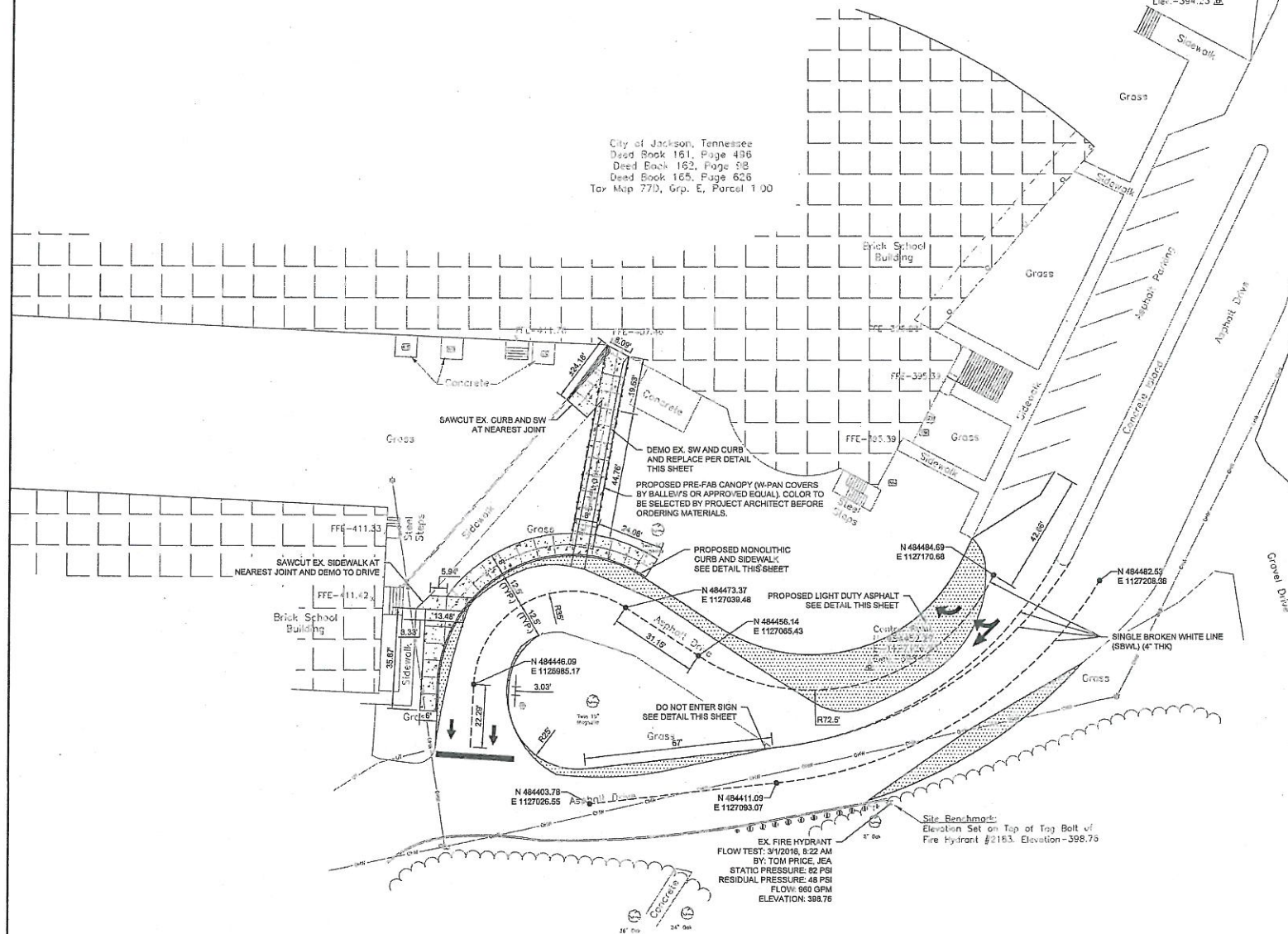

ALL EXISTING UTILITIES SHOWN BOTH ABOVE AND BELOW GROUND ARE APPROXIMATE AND ARE NOT NECESSARILY ALL THAT EXIST. THE DETERMINATION OF THE EXISTENCE AND LOCATION OF ALL UTILITIES SHALL BE THE RESPONSIBILITY OF THE CONTRACTOR

